

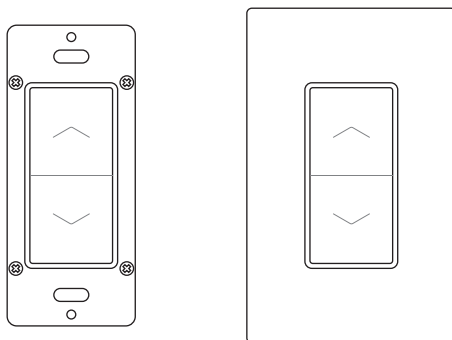

ON-PBD-705 series

Line Voltage OS-NET Button

INSTALLATION INSTRUCTIONS



INDOOR USE ONLY

Utilisation à l'intérieur Uniquement

WARNING & CAUTION

- Risk of Electrical Shock – Turn off the power at circuit breaker before installing or servicing.
- This device should be installed by a qualified electrician in accordance with electrical codes and regulations.

AVERTISSEMENT & PRUDENCE

- Risque de choc électrique - Débranchez l'alimentation avant l'entretien.
- Installer et utiliser ce dispositif conformément aux codes et règlements électriques.

OVERVIEW

The ON-PBD-705 series is an optional device of IR-TEC's OS-NET wireless mesh network solution designed to replace an existing wall switch/dimmer and broadcast manual on/off/dim control commands to the lighting group assigned.

This sleek, low profile device can be mounted into a standard NEMA wall box, operated by line voltage power, and provide wireless control required by users. Each ON-PBD-705 can be assigned to control up to 4 lighting groups via a 2-way handheld remote programmer.

A screwless snap-on Decora wall plate is supplied to create a modern, high-end appearance for all spaces. By grouping the ON-PBD-705 with OS-NET sensors and controllers, you can effortlessly achieve an energy-efficient, code-compliant smart lighting control through a state-of-the-art wireless sensor mesh network with manual controls capability for presentation or special event.

Federal Communication Commission Interference Statement

This device complies with Part 15 of the FCC Rules. Operation is subject to the following two conditions: (1) This device may not cause harmful interference, and (2) this device must accept any interference received, including interference that may cause undesired operation.

This equipment has been tested and found to comply with the limits for a Class B digital device, pursuant to Part 15 of the FCC Rules. These limits are designed to provide reasonable protection against harmful interference in a residential installation. This equipment generates, uses and can radiate radio frequency energy and, if not installed and used in accordance with the instructions, may cause harmful interference to radio communications. However, there is no guarantee that interference will not occur in a particular installation. If this equipment does cause harmful interference to radio or television reception, which can be determined by turning the equipment off and on, the user is encouraged to try to correct the interference by one of the following measures:

- Reorient or relocate the receiving antenna.
- Increase the separation between the equipment and receiver.
- Connect the equipment into an outlet on a circuit different from that to which the receiver is connected.
- Consult the dealer or an experienced radio/TV technician for help.

FCC Caution: Any changes or modifications not expressly approved by the party responsible for compliance could void the user's authority to operate this equipment.

This transmitter must not be co-located or operating in conjunction with any other antenna or transmitter.

Radiation Exposure Statement:

This equipment complies with FCC radiation exposure limits set forth for an uncontrolled environment. This equipment should be installed and operated with minimum distance 20cm between the radiator & your body.

WIRING DIAGRAM

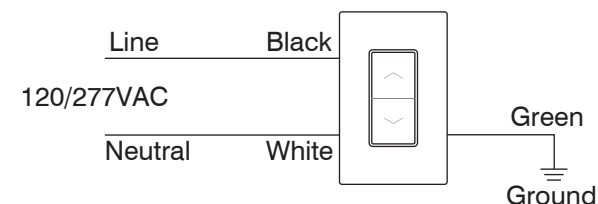

INSTALLATION

1. Lead the wires and strip the insulation with proper length for connecting.

2. Connect the wires with the device according to the wiring diagram shown above.

NOTE: The ON-PBD-705 requires connecting neutral wire for operation. To replace the existing wall switch with no neutral wire, you may substitute the switched line wire for the neutral of lighting in accordance with electrical codes and regulations.

3. Carefully set the wires and mount the device into the wall box with screws provided.

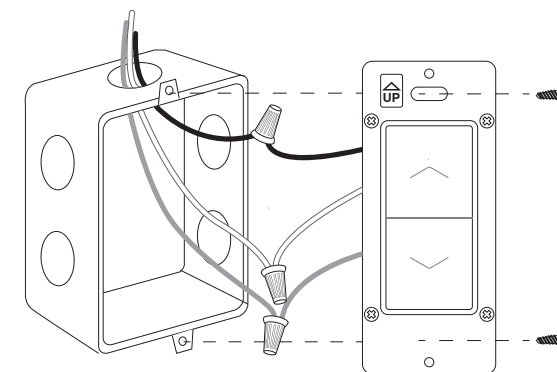

NOTE: Do NOT mount the device upside down.



www.irtec.com

This product may be covered by one or more U.S. patents or patent applications. Please visit www.irtec.com for more information.

Printed in Taiwan

PRELIMINARY



GROUP LINK

After installing completed, the ON-PBD-705 requires grouping to link with the OS-NET network. To group and link the device, you would need an SRP-281 OS-NET Remote Programmer to conduct the grouping process by pointing toward the target device. Refer to the OS-NET Programming Guide available from www.irtec.com for more details about grouping procedures.

NOTE: Grouping data can be read on the remote by conducting a download process with the remote face to the device.

Programming Guide

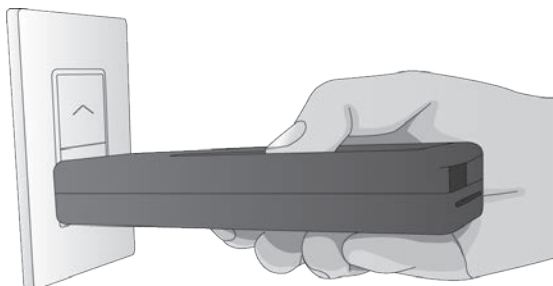

SPECIFICATIONS

Power voltage	120/277VAC, 50/60 Hz
Wireless protocol	Modified Zigbee Light Link (ZLL)
Radio frequency	2.4 GHz
Radio range	Typical 50 ft. @indoor
Op. humidity	Max 95% non-condensation
Op. temperature	-14°F ~ 122°F (-10°C ~ 50°C)
Dimensions	4.13"H x 1.77"W x 1.65"D (w/mounting plate)

OPERATION

A short press at upper/lower position of the button will transmit a command to turn on/off the lighting of groups assigned. Press and hold at upper/lower position of the button will increase/decrease the output level of grouped lighting respectively.

1. Turn On the light

A SHORT press (≤ 0.5 second) at the UPPER part of button will transmit a command to turn on the grouped lighting. Light will stay on as long as the grouped sensor(s) detects the occupancy, and the grouped sensor/controller will resume control after the area is vacated.

2. Turn Off the light

A SHORT press (≤ 0.5 second) at the LOWER part of button will transmit a command to turn off the grouped lighting. The grouped sensor/controller will resume control after the delay time elapsed.

3. Ramp up the light

A LONG press (≥ 0.5 second) at the UPPER part of button will enter into dimming adjustment mode to increase the output level of grouped lighting. Intermittent press on the button during dimming control mode will adjust the output level step by step. The device will exit from dimming adjustment mode 2 seconds after the last button operation.

4. Fade down the light

A LONG press (≥ 0.5 second) at the LOWER part of button will enter into dimming adjustment mode to decrease the output level of grouped lighting. Intermittent press on the button during dimming control mode will adjust the output level step by step. The device will exit from dimming adjustment mode 2 seconds after the last button operation.

NOTE: After changing the dim level, allow the LED bar to turn off before trying to switch on/off.

DIMENSIONS

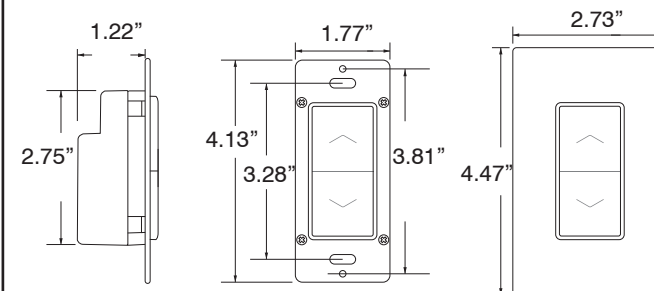

WARRANTY

IR-TEC International Ltd. warrants this product to be free of defects in materials or workmanship for a period of five years from date of shipment. There are no obligations or liabilities on the part of IR-TEC International Ltd. for consequential damages arising out or in connection with the use or performance of this product or other indirect damages with respect to loss of property, revenue, profit, or cost of removal, installation or reinstallation.