

IR-TEC明和電子感應器提供了多種安裝配件，來滿足各種使用的場所及安裝方式。

### 吸頂式安裝配件

#### S-mount with SMB-500

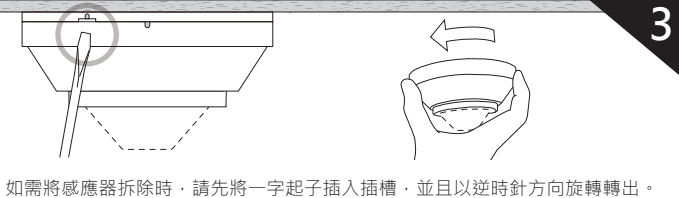
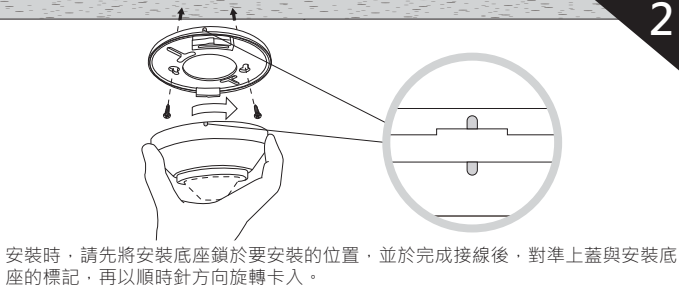
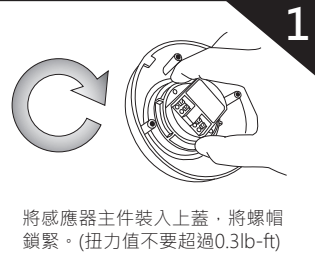
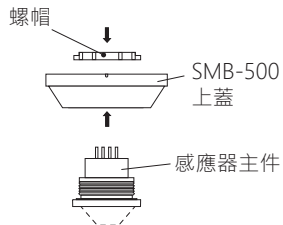
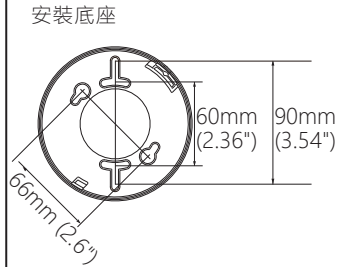
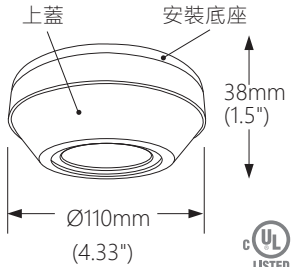

### 吸頂埋入安裝配件

#### C-mount with CMB-500

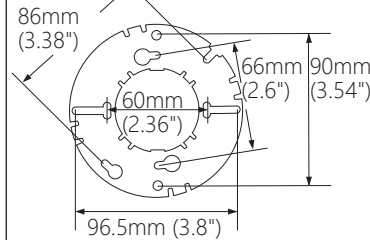
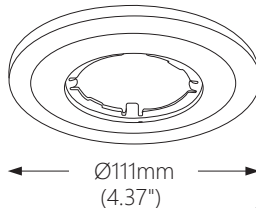

先將感應器上的光學鏡片卸下，再裝入安裝底座

對準溝槽

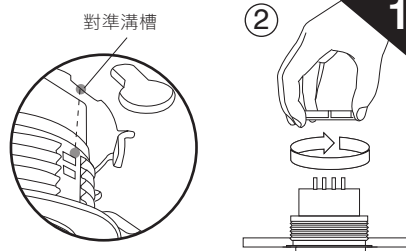
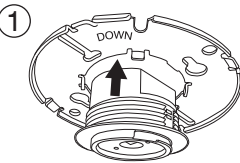

將感應器裝入安裝底座後，並將螺帽鎖緊。(扭力值不要超過0.3lb-ft)

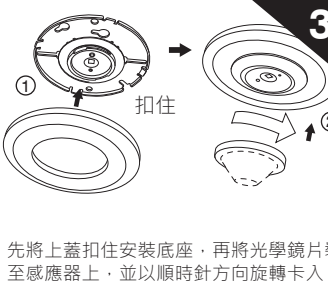
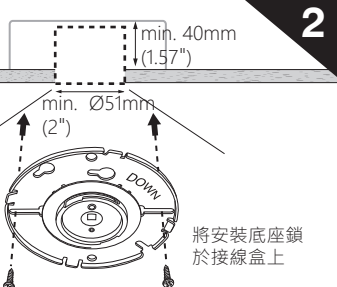

接線盒

### 吸頂嵌入安裝配件

#### R-mount with RMB-500

### 吸頂嵌入安裝配件

#### L-mount with LMB-500

開孔尺寸為70mm圓孔

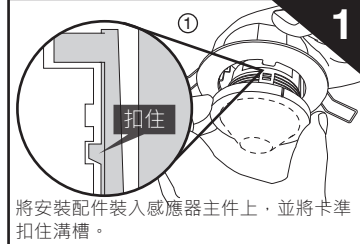
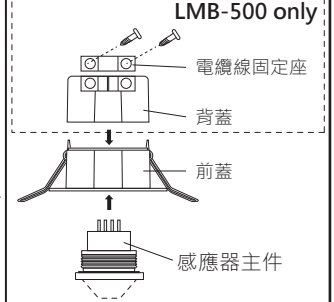
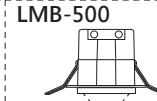
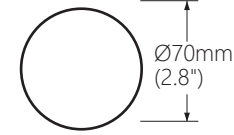

搭配LMB-500使用時，請先將電纜線穿過背蓋再接上感應器，再把背蓋卡入前蓋後，將電纜線固定座鎖緊。

注意事項：出線式感應器，保留長度跟剥皮的長度如下：

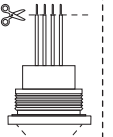

保留線長：30-50mm  
剥皮長度：8-11mm

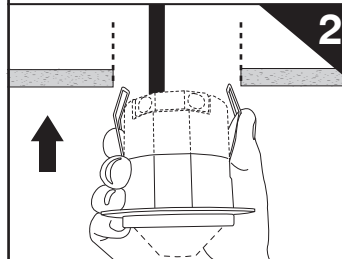
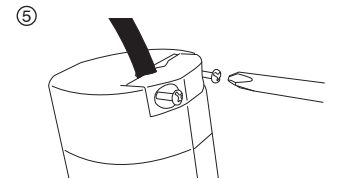
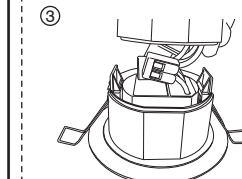
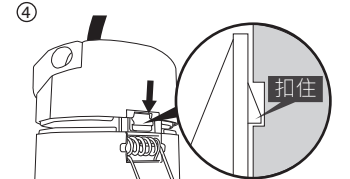
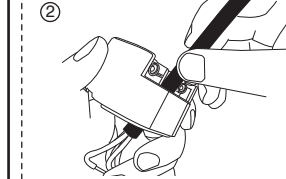

將彈簧向上拉開並壓住，再嵌入要安裝的開孔內。

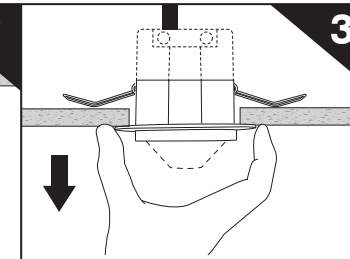

如需將感應器拆除時，請抓緊感應器，並向下拉出。

**感應器主件** F-mount

**防水型感應器主件** W-mount

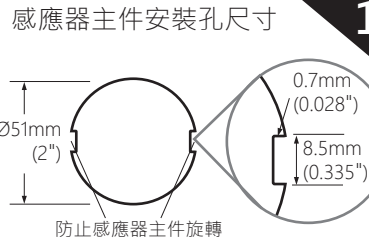
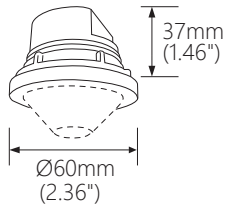

防止感應器主件旋轉

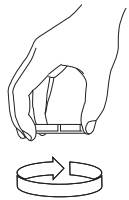
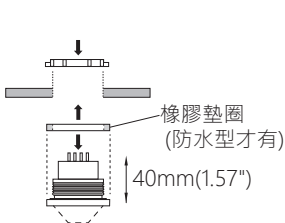

將感應器主件裝入安裝孔內，並將螺帽鎖緊。  
(扭力值不要超過 0.3lb-ft)

注意: 防水型感應器主件在安裝時，務必確認橡膠墊圈是在燈具外側與感應器之間。

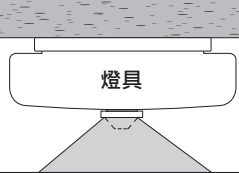

**內隱式安裝配件** I-mount with IMB-500  
(HFD感應器專屬配件)

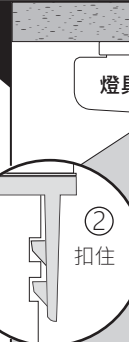
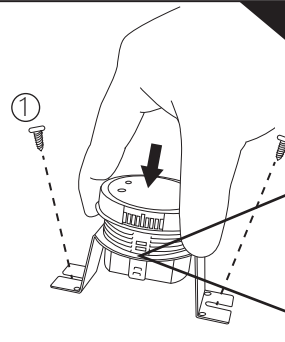
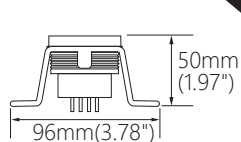
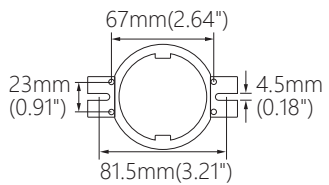

扣住

**燈具外掛安裝配件** E-mount with EMB-500

**防水型燈具外掛安裝配件** P-mount with PMB-500

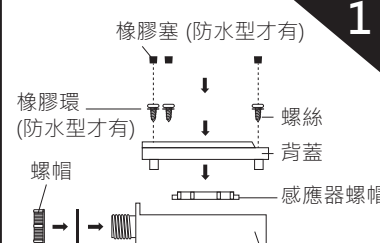
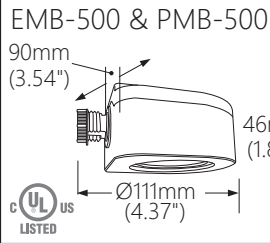

安裝於燈具側邊1/2"盲孔上

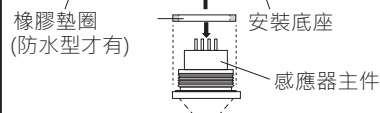

**感應器接線方式為出線式時**

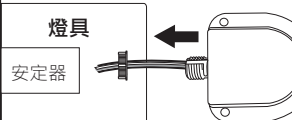
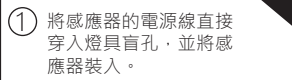

將螺帽鎖緊

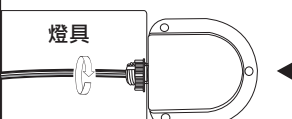

注意: 防水型燈具外掛安裝配件在安裝時，務必確認橡膠墊圈是在燈具外側與感應器之間。



安裝於燈桿

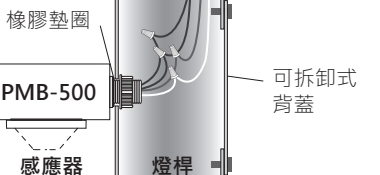

**其他配件**

**延伸安裝支架** EMA-500

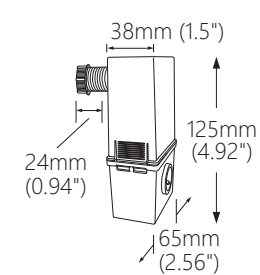

當燈具本體高度太高或是燈罩會遮蔽到燈具外掛型感應器時，可搭配延伸安裝支架，以確保感應器不會被遮蔽到。

**延伸安裝支架與燈具外掛安裝配件結合**

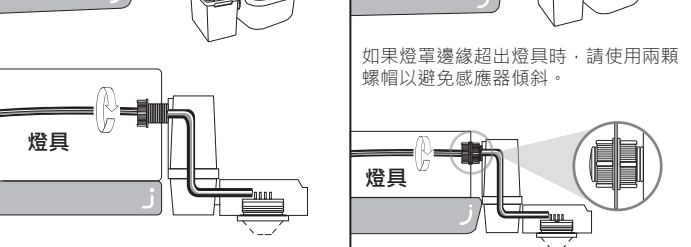
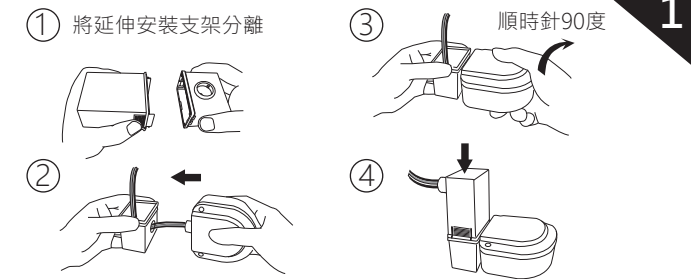

如果燈罩邊緣超出燈具時，請使用兩顆螺帽以避免感應器傾斜。

**延伸接頭** EJ-30 / EJ-50 / EL-40

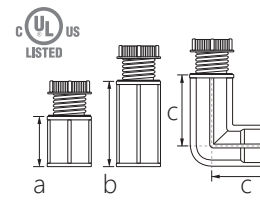

a EJ-30 30mm (1.18 inch)  
b EJ-50 50mm (1.97 inch)  
c EL-40 40mm (1.57 inch)



燈具外掛安裝配件可搭配EJ-30/EJ-50/EL-40，使固定安裝位置得以延長30mm/50mm/40mm(L型)，如需延伸其它長度，可搭配多個延伸接頭使用。如需用於防水型燈具外掛安裝配件時，請訂購EJ-30F/EJ-50F/EL-50F。